



FROM STATIC TO INFLATABLE SEALS

# **PTD** **UPGRADE KIT**

## HOW TO INSTALL THE INFLATABLE KIT ON YOUR PTD DIVERTER VALVE

This is an addition to the Diverter Valves Installation, Operation and Maintenance Manual (IOM) listed on the technical support page (accessible through QR code on the valve, or clicking [the link](#))

*This manual provides information useful to someone skilled to the level of a technical specialist.*

Please follow the IOM on the technical support page until chapter 10.4.2.4

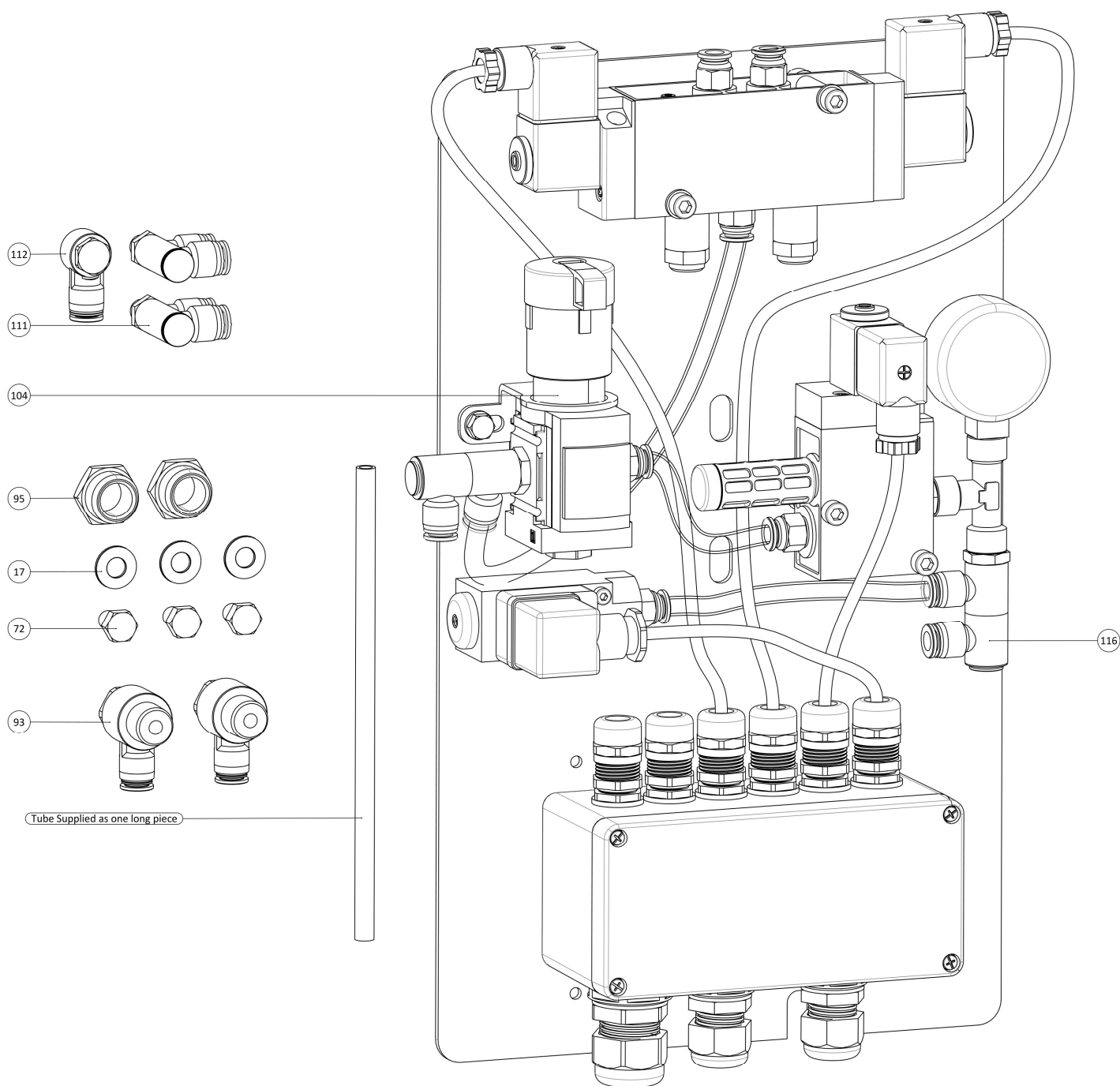

PTD upgrade kit static -> inflatable seal

## BEFORE YOU START

Confirm you have a PTD 'inflatable seal ready' prior to order by checking for three setscrews near the seals. (marked in red).

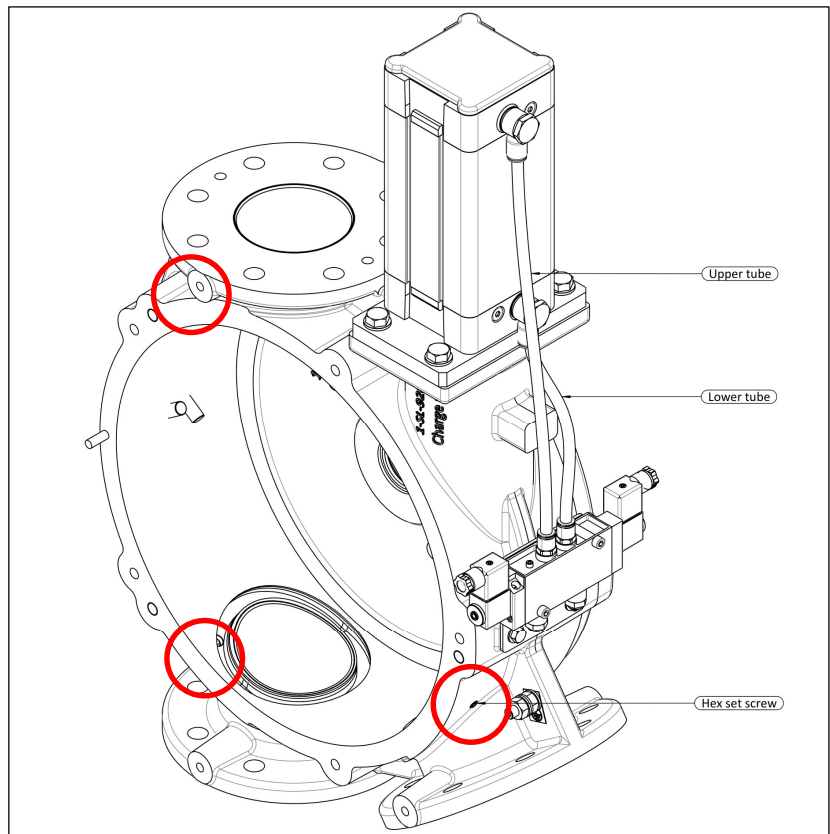

## Step 1

Remove the tubes between the actuator and solenoid valve by pushing on the coupling ends. These tubes will not be used anymore.

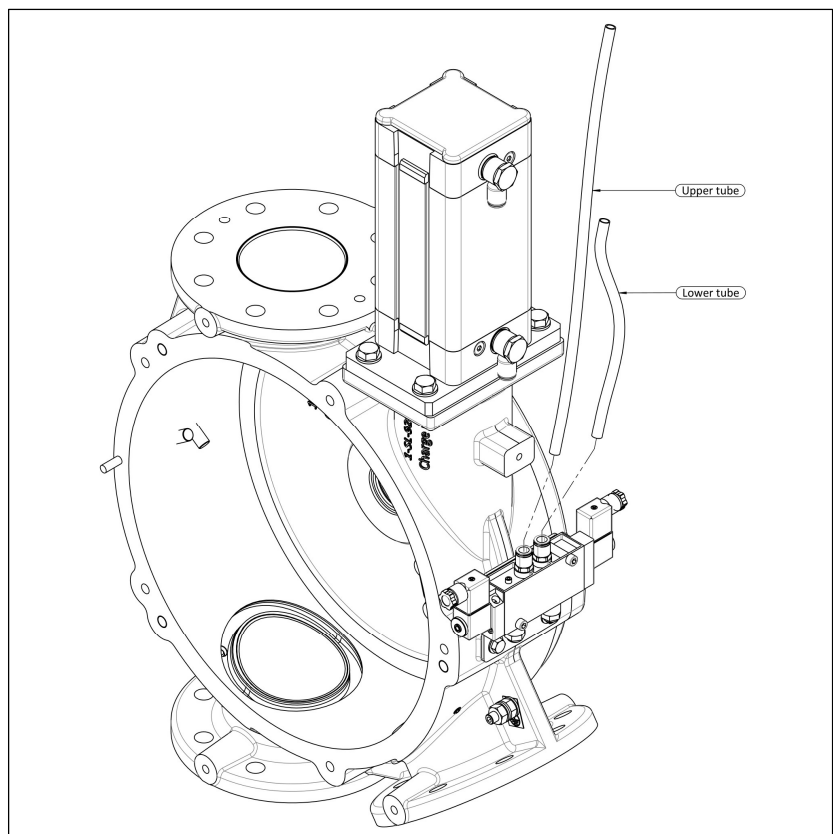

## Step 2

Remove the couplings (93) from the actuator using a wrench.  
These couplings will not be used anymore.

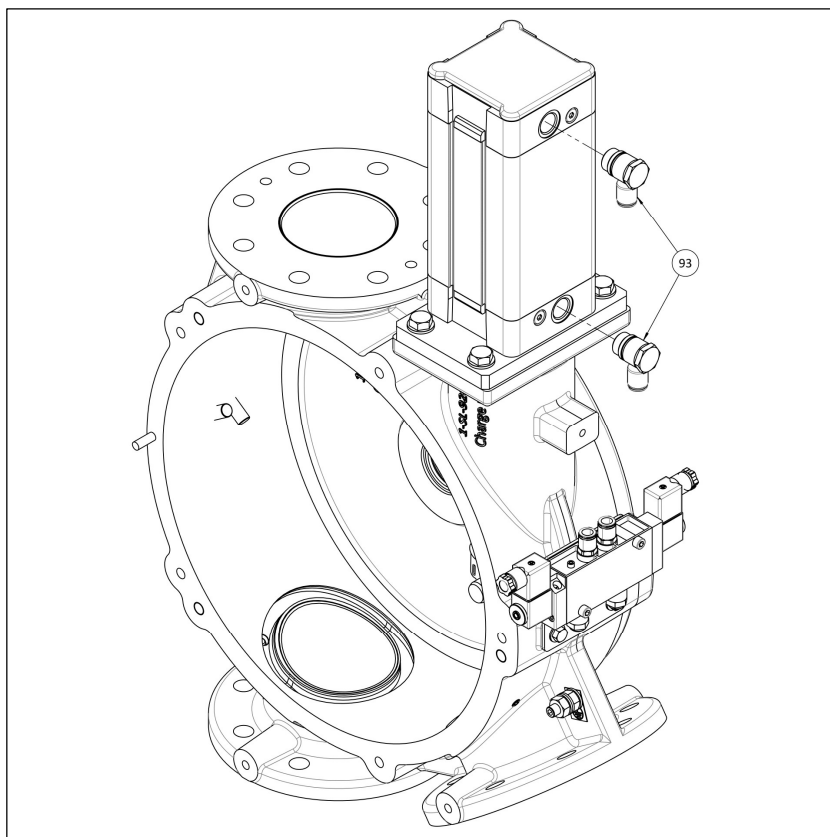

## Step 3

Disconnect the pneumatic assembly by removing its two hex bolts.  
New bolts are supplied in the upgrade kit.

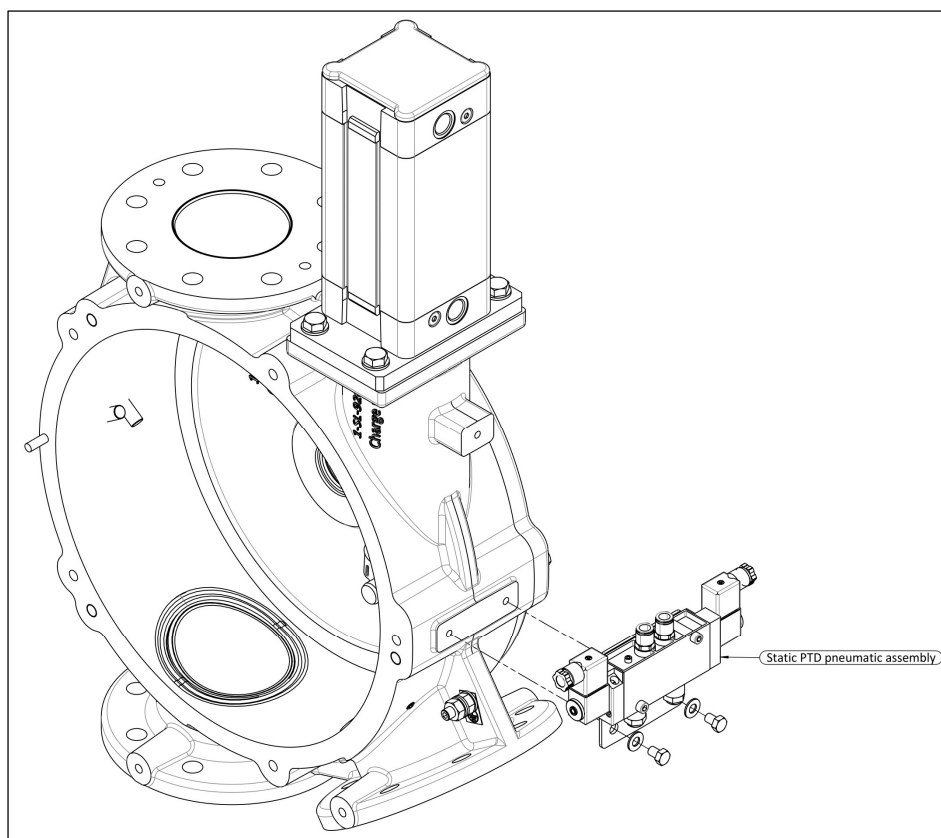

#### Step 4

Remove the three hex set screws near the seals.  
(marked in red)

The hex screws will not be used anymore.

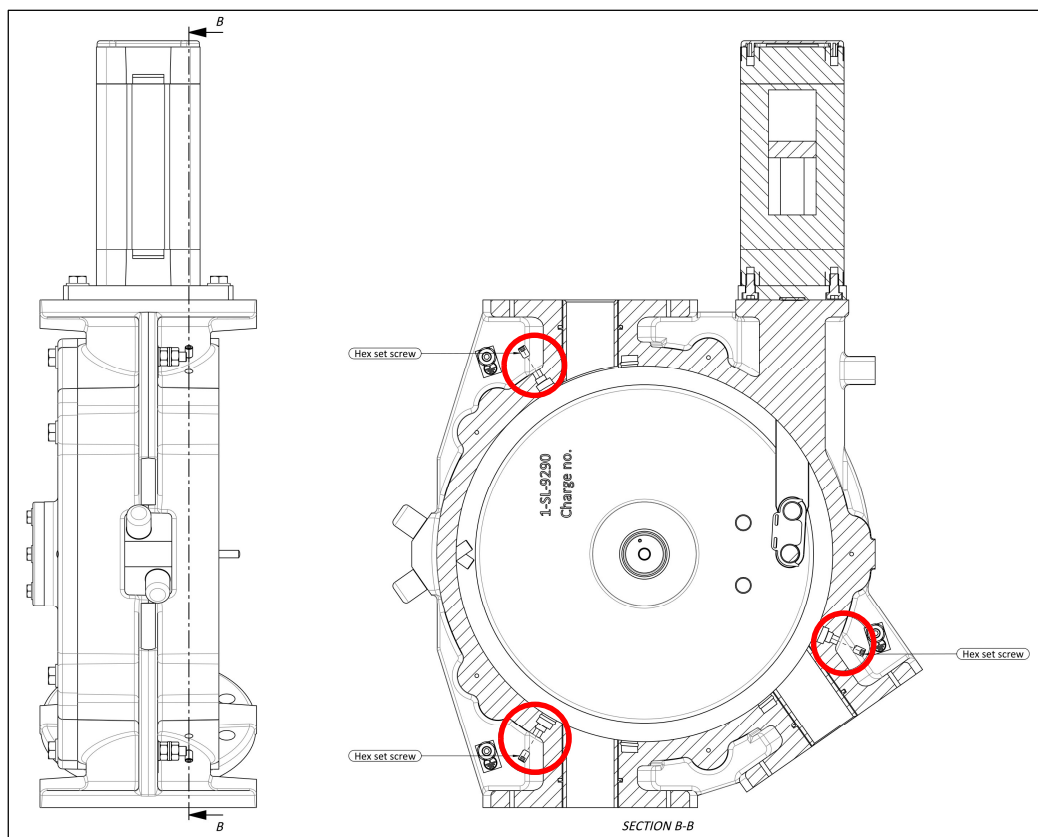

#### Step 5

Replace the 3 hex set screws with the new couplings (111&112) visible on page 2 near the seals. (marked in red)

Be aware of the different coupling at the diverted flange.

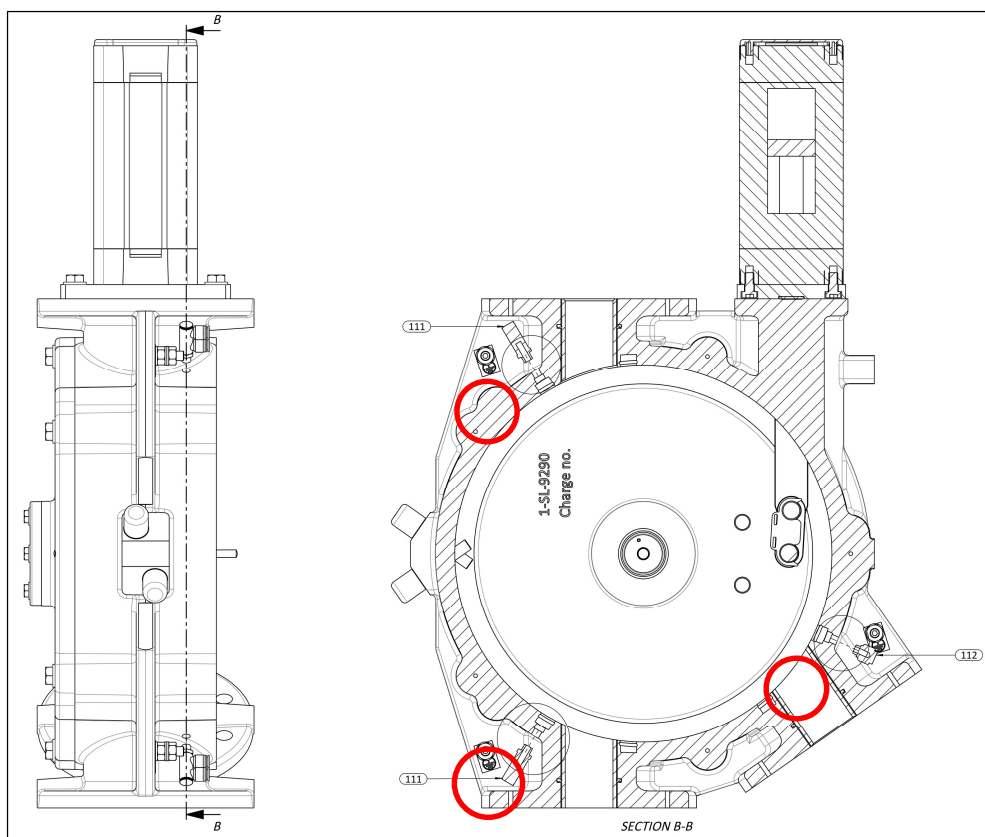



## Step 6

Connect the new couplings on the body to each other using the tube, cut this tube to the required lengths. Then connect the new L-shaped couplings (95) with adaptor (93) to the actuator.

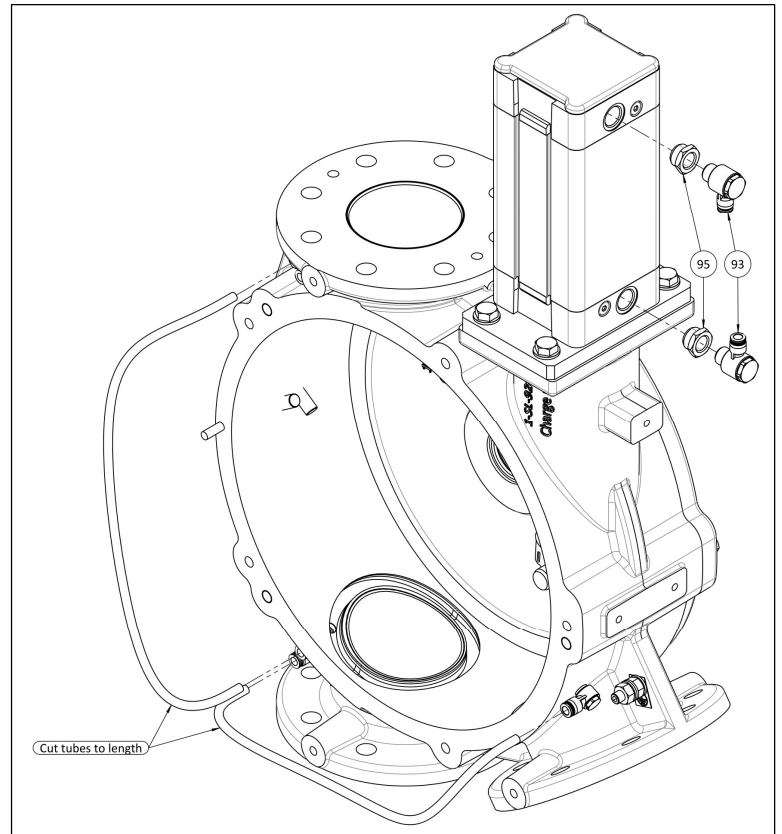

## Step 7

Install the PTD upgrade kit onto the PTD using the three new sets of bolts and washers (17&72) provided.

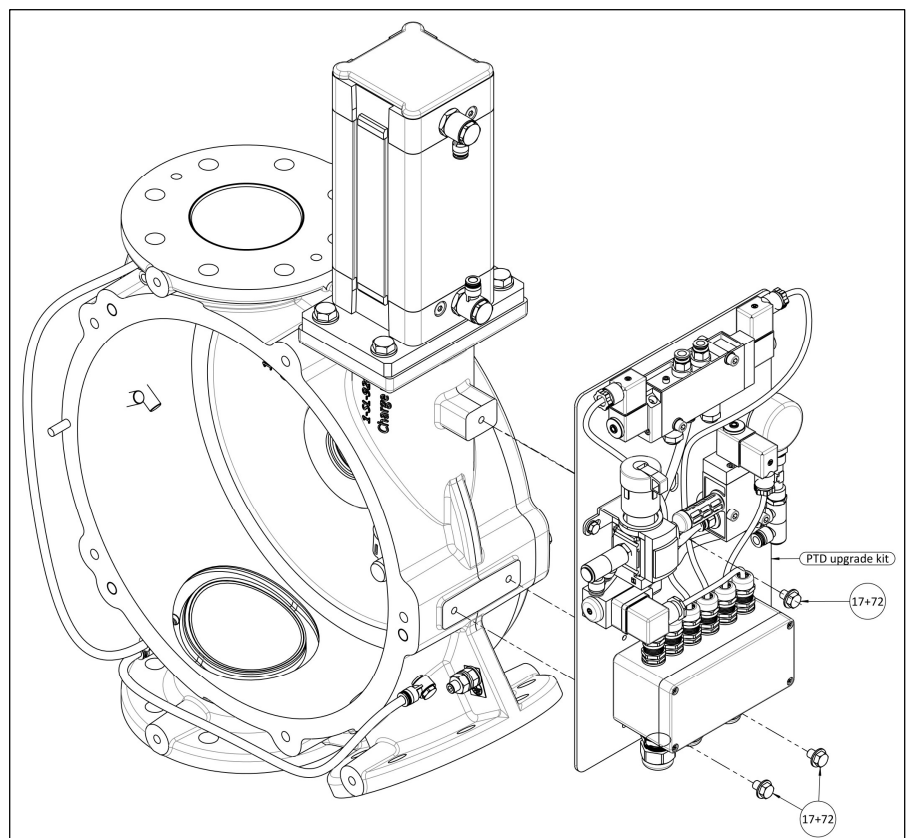

## Step 8

Connect the tubes (cut to required length) from the solenoid valve (42) to the actuator and connect a tube to the pneumatic plate using the coupling below the pressure gauge (116). Cut the tube to the required length.

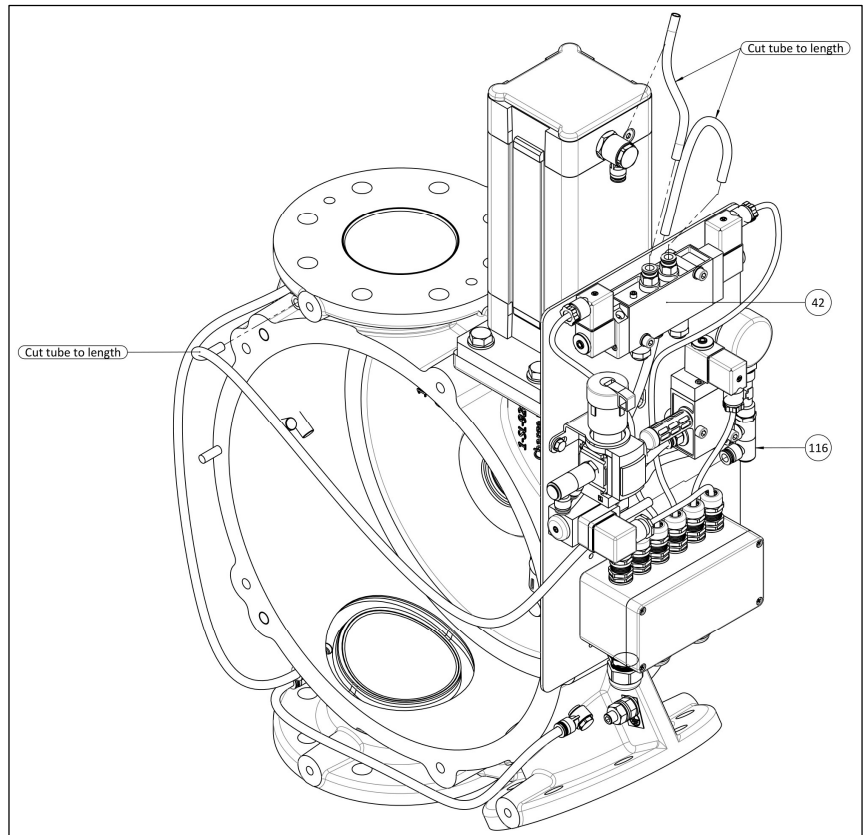

## Step 9

Finally, install the three inflatable seals (4) as described in the Diverter Valves IOM. These inflatable seals have to be ordered separately.

Set the seal pressure as desired by looking at the left pressure gauge (104) and turning the knob. Clockwise increases seal pressure, counterclockwise decreases seal pressure.

*Difference between conveying pressure and pressure on the seals must be min. 1 bar.*  
*Standard pressure of the inflatable seals is set at 4,5 bar*  
*Max pressure of the seals is 6-7 bar*

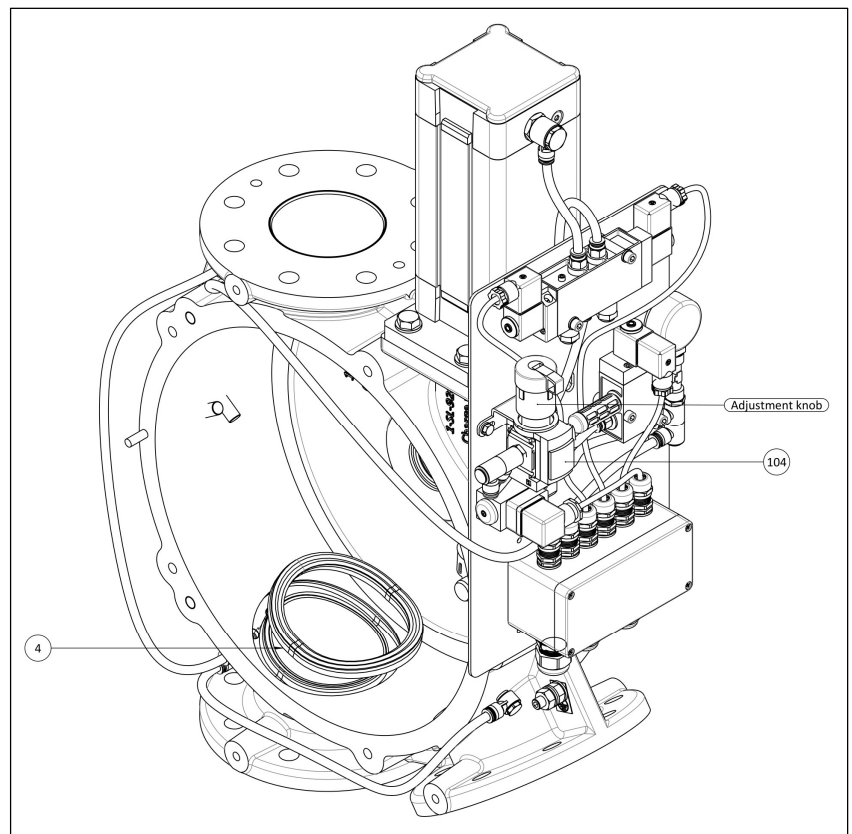

**You now have a PTD with inflatable seals.**

From this point please follow the Diverter Valves IOM inflatable seal for re-assembly.

*Continue on chapter 10.4.2.3*