



DUAL PIPE PLUG DIVERTER – PTD-II

The PTD-II plug type diverters have been specially designed to route powders and pellets with minimum degradation in pneumatic conveying systems.

Precision machining, proper sealing, and an obstruction-free internal geometry guarantee a smooth passage of product.

The user-friendly foolproof design enables quick on-site internal examination, cleaning and, when necessary, replacement of seals.

The PTD-II design conforms to all current legislation regarding safety in the workplace. Consequently, there are no moving parts on the outside.

Available sizes

Size PTD-II	50	65	80	100	125	150	200
-------------	----	----	----	-----	-----	-----	-----



Specifications

- ▶ Pressure shock-resistant up to 145 PSI*
- ▶ Two-channel design
- ▶ Minimal maintenance
- ▶ Compact form
- ▶ User-friendly design
- ▶ No moving parts on the outside
- ▶ Pressure up to 43.5 PSI with static seals
- ▶ Sizes 50-150 up to 87 PSI with inflatable seals
- ▶ Versions with electrical drive available
- ▶ Wear-resistant pipes optionally available
- ▶ ATEX 2014/34/EU certification available
- ▶ EC1935/2004 conformity available

* Size 200 excluded

Product Information

The PTD-II plug type diverter consists of an aluminium housing and end covers installed with a plug with two pipes. All product contact surfaces are stainless steel AISI 316/DIN 1.4404. Three FDA/EC 1935/2004 approved silicone seals guarantee the sealing between housing and plug. The body is pressure-tight, ensuring no leakage to the atmosphere.

The standard diverter can be used in systems with positive pressures up to 43.5 PSI (static seals). The sizes 50-150 are optionally available for pressures up to 87 PSI (inflatable seals).

The PTD-II is supplied with a complete electro-pneumatic control system, including solenoids and inductive position sensors.

The standard diverter is suitable for product temperatures ranging from -13°F up to +176°F at ambient temperatures of +14°F up to +104°F. Versions for higher temperatures are available on request.

Application

The PTD-II is suitable for the following industries:

- | | | |
|------------------|---------------|-------------|
| ▶ Plastics | ▶ Chemicals | ▶ Minerals |
| ▶ Food | ▶ Biomass | ▶ Recycling |
| ▶ Pet food | ▶ Aquaculture | ▶ Batteries |
| ▶ Animal feed | ▶ Dairy | ▶ Tires |
| ▶ Pharmaceutical | ▶ Cosmetics | |
| ▶ Infant formula | ▶ Paint | |

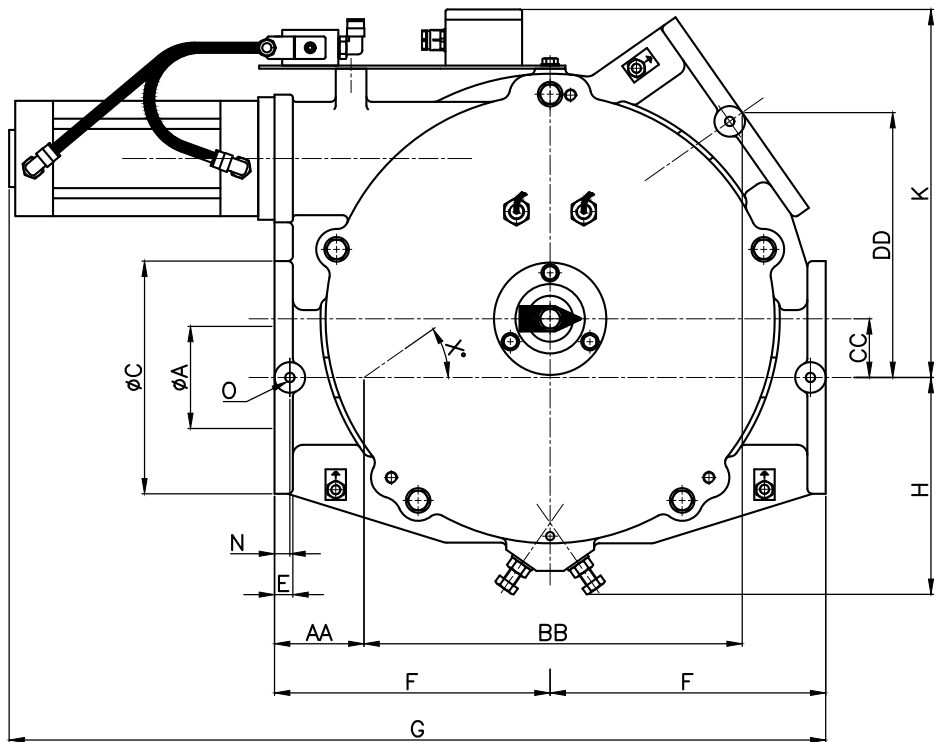
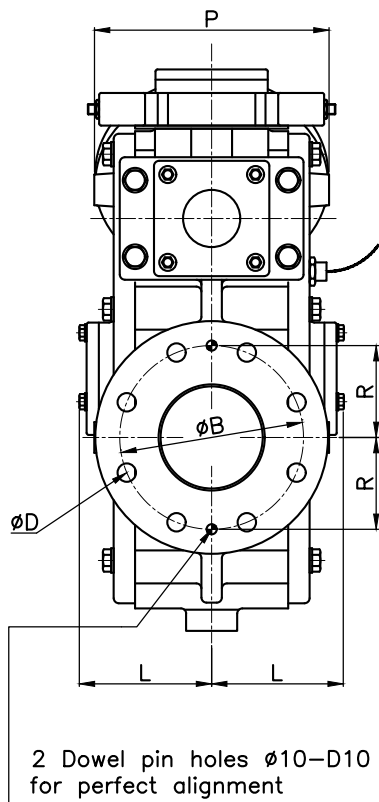

TYPE	DIN				ANSI															
	$\text{Ø}A$	$\text{Ø}B$	D	$\text{Ø}C$	$\text{Ø}B$	D	E	F	G	H	K	L	N	O	P	X°	AA	BB	CC	DD
50	1.97	4.92	4x $\text{Ø}0.71$	6.50	4.75	4x $\text{Ø}0.75$	0.63	8.07	24.33	6.69	10.55	4.41	0.49	M10x20	6.69	33.5	3.50	10.55	1.38	6.97
65	2.56	5.71	4x $\text{Ø}0.71$	7.28	5.50	4x $\text{Ø}0.75$	0.63	8.46	26.69	7.09	11.46	4.61	0.49	M10x20	7.48	36.7	3.43	10.83	1.67	8.07
80	3.15	6.30	8x $\text{Ø}0.71$	7.87	6.00	4x $\text{Ø}0.75$	0.71	10.04	30.24	7.68	12.87	5.00	0.59	M10x20	8.07	36.6	4.25	12.68	1.91	9.45
100	3.94	7.09	8x $\text{Ø}0.71$	8.98	7.50	8x $\text{Ø}0.75$	0.71	10.63	32.01	8.83	14.21	5.12	0.59	M10x20	9.06	35	3.46	14.57	2.26	10.24
125	4.92	8.27	8x $\text{Ø}0.71$	9.84	8.50	8x $\text{Ø}0.87$	0.79	13.19	39.02	10.43	17.05	5.87	0.69	M12x24	10.04	35.5	4.57	17.76	2.76	12.68
150	5.91	9.45	8x $\text{Ø}0.87$	11.22	9.50	8x $\text{Ø}0.87$	0.79	14.76	41.77	11.61	18.90	6.54	0.79	M12x24	11.50	35.8	4.72	20.12	3.25	14.53
200	8.31	11.61	8x $\text{Ø}0.87$	13.50	11.75	8x $\text{Ø}0.87$	0.98	19.69	51.02	14.96	24.33	7.83	0.98	M12x20	13.78	34.8	5.24	28.03	4.53	19.49

* Standard pre-drilled for cast iron

Technical modifications are possible, dimensions in inches.